

HUNDRED OF NURIOOTPA
 ALLOTMENT 2003 IN D91246
 IN THE AREA NAMED HEWETT
 COUNCIL LIGHT REGIONAL COUNCIL
 CT 6110/664
 SUBJECT TO SURVEY

APPLICANT: REDAN PTY. LTD.
 AGENT: MICHAEL GREAR SURVEYS
 REGISTERED PROPRIETORS:
 McFATHOM DEVELOPMENTS PTY. LTD.

DEVELOPMENT ACT 1993 ZONING - RESIDENTIAL
 DEVELOPMENT PLAN IN LIGHT REGIONAL COUNCIL
 TOTAL AREA 6533 m2
 No. OF EXISTING ALLOTMENTS 1
 No. OF PROPOSED ALLOTMENTS (NOT INCLUDING ROADS OR RESERVES) 10
 No OF ADDITIONAL ALLOTMENTS 9
 LENGTH OF ROAD -
 CONTOUR INTERVAL 0.5m
 LEVEL DATUM AHD
 CONTOURS DERIVED FROM FIELD SURVEY 16/03/2011

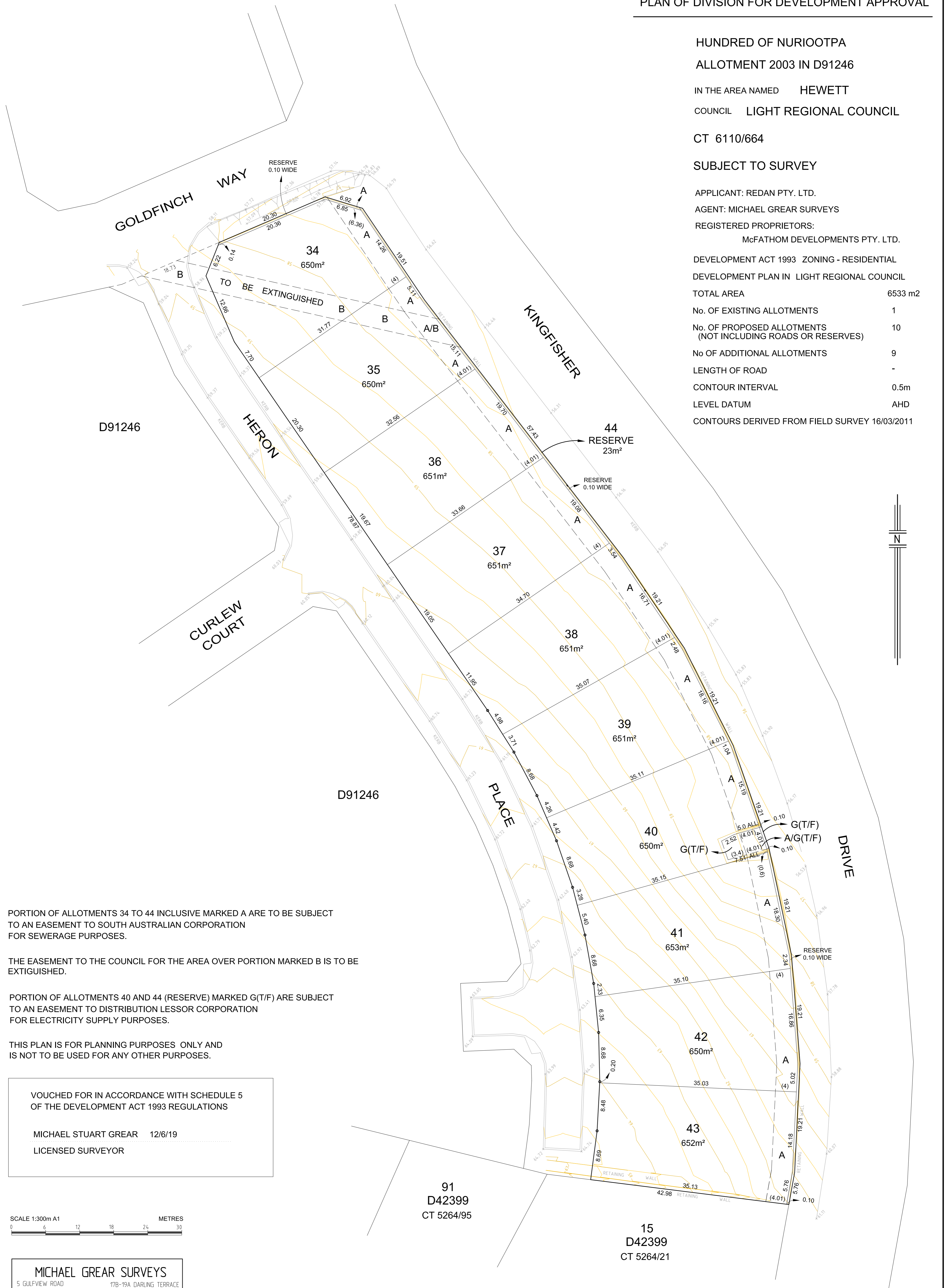

PORTION OF ALLOTMENTS 34 TO 44 INCLUSIVE MARKED A ARE TO BE SUBJECT TO AN EASEMENT TO SOUTH AUSTRALIAN CORPORATION FOR SEWERAGE PURPOSES.

THE EASEMENT TO THE COUNCIL FOR THE AREA OVER PORTION MARKED B IS TO BE EXTINGUISHED.

PORTION OF ALLOTMENTS 40 AND 44 (RESERVE) MARKED G(T/F) ARE SUBJECT TO AN EASEMENT TO DISTRIBUTION LESSOR CORPORATION FOR ELECTRICITY SUPPLY PURPOSES.

THIS PLAN IS FOR PLANNING PURPOSES ONLY AND IS NOT TO BE USED FOR ANY OTHER PURPOSES.

VOUCHED FOR IN ACCORDANCE WITH SCHEDULE 5 OF THE DEVELOPMENT ACT 1993 REGULATIONS

MICHAEL STUART GREAR 12/6/19
 LICENSED SURVEYOR



MICHAEL GREAR SURVEYS
 5 GULFVIEW ROAD BLACKWOOD SA 5051
 PHONE: (08) 8278 8732
 FAX: (08) 8278 8050
 REF: 2019093-1

17B-19A DARLING TERRACE WHYALLA SA 5600
 PHONE: 0644 2040
 FAX: (08) 8278 8050
 ABN: 93205344714

91 D42399 CT 5264/95

15 D42399 CT 5264/21