

Stage 3
Building Envelope Plan

Key Plan

Scale 1:2000 @ A3



Oakford Estate
EYRE



Legend

Not to Scale

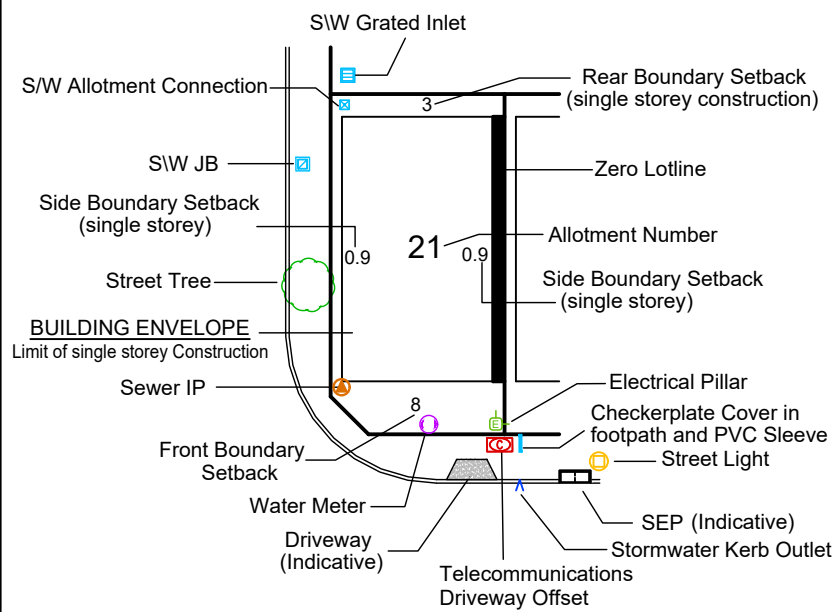

NOTE:

- The Allotment Development Plan must be read in conjunction with the written guidelines.
- Refer to key plan for envelope offset dimensions.
- Envelope boundary offsets based on the City of Playford Development Plan guidelines for developments in "Suburban Neighbourhood Zone".
- Front boundary setback distance applicable to dwelling only.
- All garages and carports must be a minimum of 5.5 metres from the front boundary.
- Subject to confirmation of Easements.
- Subject to final road design.
- Building on the boundary subject to council consent.
- T/F Denotes Transformer.
- Driveways will be constructed as part of the civil works.
- All distances shown are in metres

REVISION	DATE	
1	AMEND SETBACKS & BDY BUILDS ON ALLOTS 61 - 66	22/11/21
0	ISSUED FOR REVIEW AND COMMENT	04/11/21

REV : 1 DRAWING : 17681-52-4-SV-BA1-R1
INST : 17681/52/4 DATE : 22/11/2021
DRAWN : FYF CHECKED : JJB



Original Sheet Size A3

Stage 3
Building Envelope Plan

Plan A

Scale 1:500 @ A3



Oakford Estate
EYRE

Legend
Not to Scale

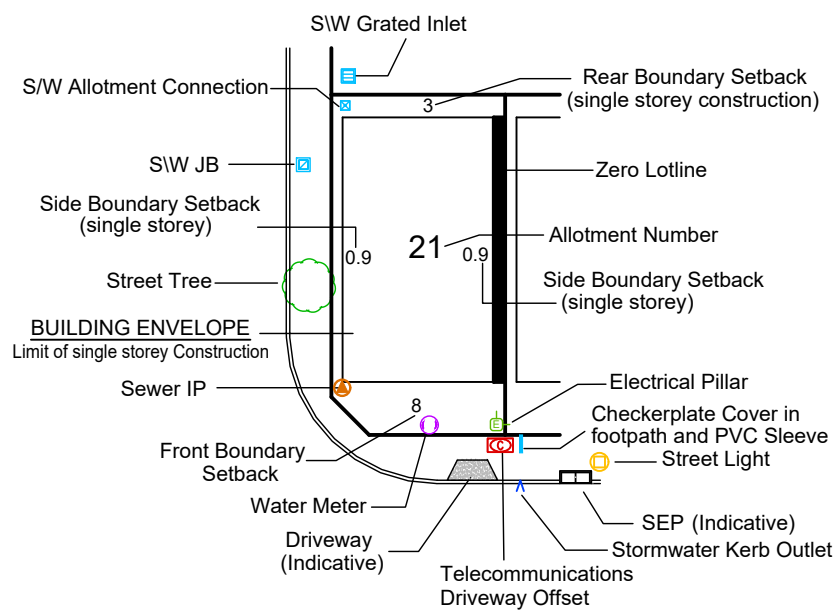

NOTE:

- The Allotment Development Plan must be read in conjunction with the written guidelines.
- Refer to key plan for envelope offset dimensions.
- Envelope boundary offsets based on the City of Playford Development Plan guidelines for developments in "Suburban Neighbourhood Zone".
- Front boundary setback distance applicable to dwelling only.
- All garages and carports must be a minimum of 5.5 metres from the front boundary.
- Subject to confirmation of Easements.
- Subject to final road design.
- Building on the boundary subject to council consent.
- T/F Denotes Transformer.
- Driveways will be constructed as part of the civil works.
- All distances shown are in metres

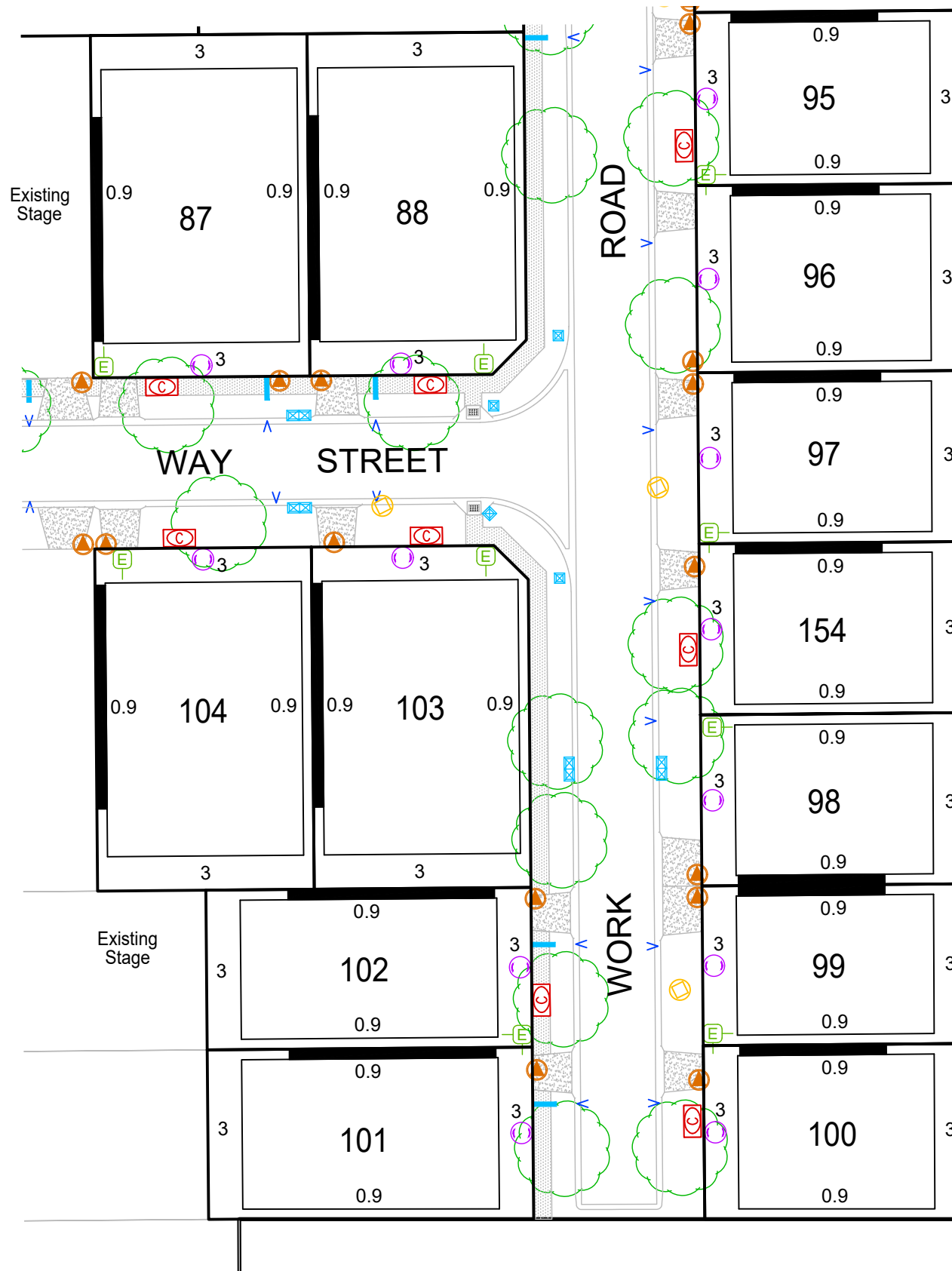

REVISION	DATE	
1	AMEND SETBACKS & BDY BUILDS ON ALLOTS 61 - 66	22/11/21
0	ISSUED FOR REVIEW AND COMMENT	04/11/21
REV : 1	DRAWING : 17681-52-4-SV-BA1-R1	
INST : 17681/52/4	DATE : 22/11/2021	
DRAWN : FYF	CHECKED : JJB	



Original Sheet Size A3

Stage 3
Building Envelope Plan

Plan B

Scale 1:500 @ A3



Oakford Estate
EYRE

Legend
Not to Scale

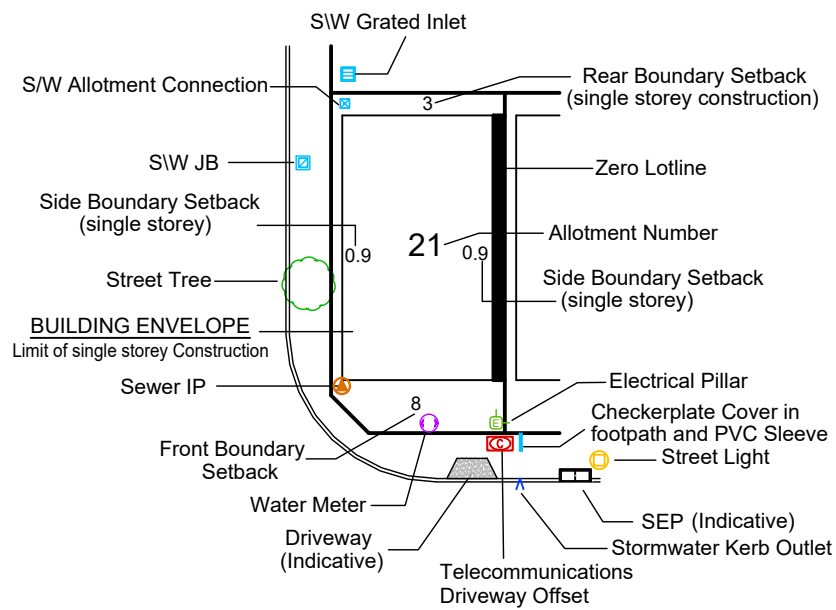

NOTE:

- The Allotment Development Plan must be read in conjunction with the written guidelines.
- Refer to key plan for envelope offset dimensions.
- Envelope boundary offsets based on the City of Playford Development Plan guidelines for developments in "Suburban Neighbourhood Zone".
- Front boundary setback distance applicable to dwelling only.
- All garages and carports must be a minimum of 5.5 metres from the front boundary.
- Subject to confirmation of Easements.
- Subject to final road design.
- Building on the boundary subject to council consent.
- T/F Denotes Transformer.
- Driveways will be constructed as part of the civil works.
- All distances shown are in metres

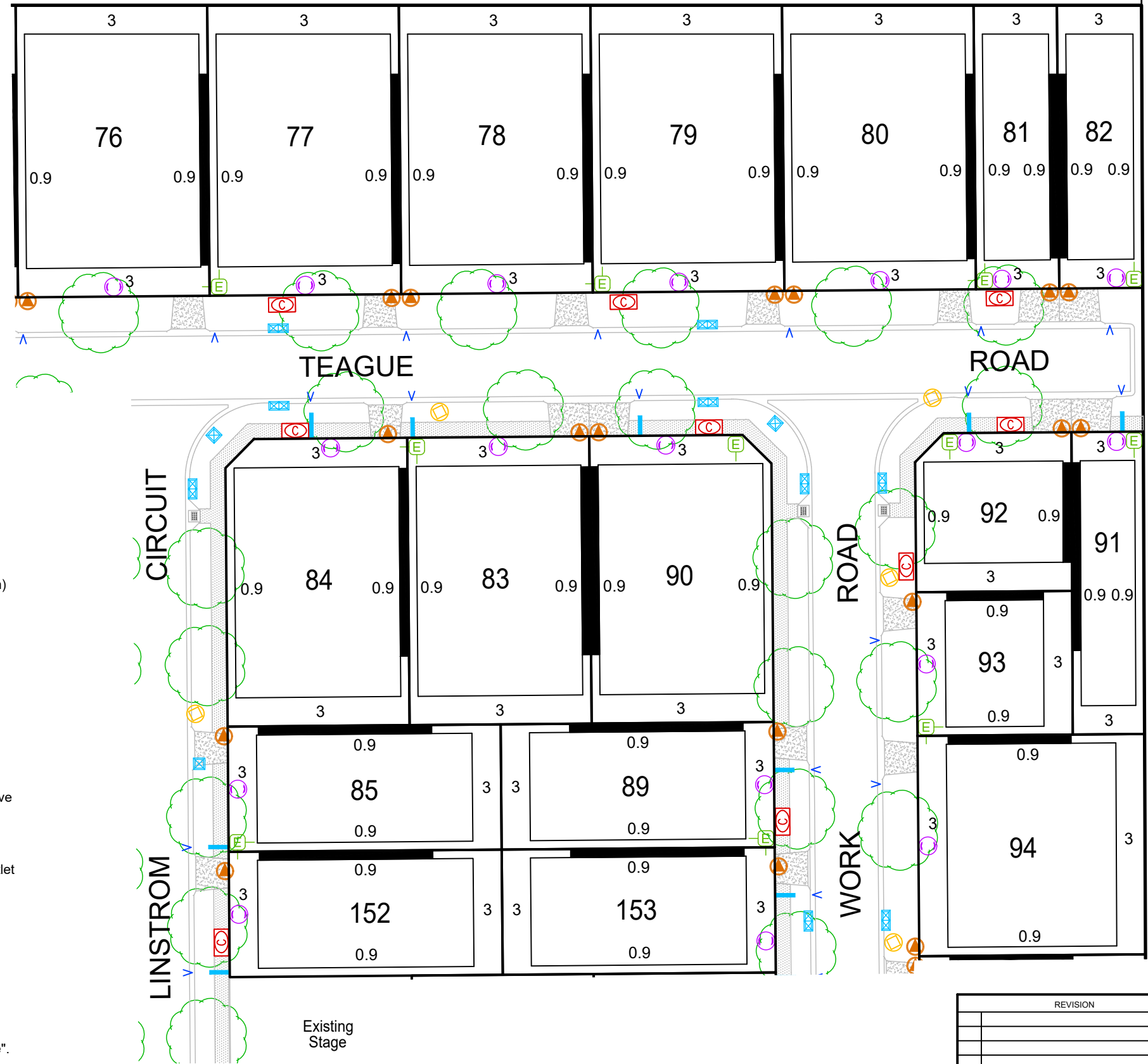

REVISION	DATE	
1	AMEND SETBACKS & BDY BUILDS ON ALLOTS 61 - 66	22/11/21
0	ISSUED FOR REVIEW AND COMMENT	04/11/21
REV : 1	DRAWING : 17681-52-4-SV-BA1-R1	
INST : 17681/52/4	DATE : 22/11/2021	
DRAWN : FYF	CHECKED : JJB	



Original Sheet Size A3

Stage 3
Building Envelope Plan

Plan C

Scale 1:500 @ A3



Oakford Estate
EYRE

Legend
Not to Scale

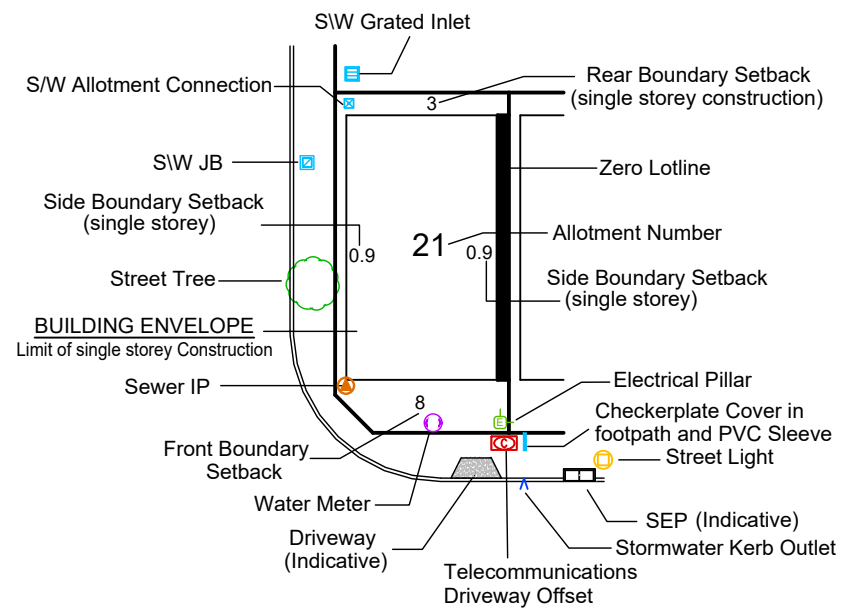

NOTE:

- The Allotment Development Plan must be read in conjunction with the written guidelines.
- Refer to key plan for envelope offset dimensions.
- Envelope boundary offsets based on the City of Playford Development Plan guidelines for developments in "Suburban Neighbourhood Zone".
- Front boundary setback distance applicable to dwelling only.
- All garages and carports must be a minimum of 5.5 metres from the front boundary.
- Subject to confirmation of Easements.
- Subject to final road design.
- Building on the boundary subject to council consent.
- T/F Denotes Transformer.
- Driveways will be constructed as part of the civil works.
- All distances shown are in metres

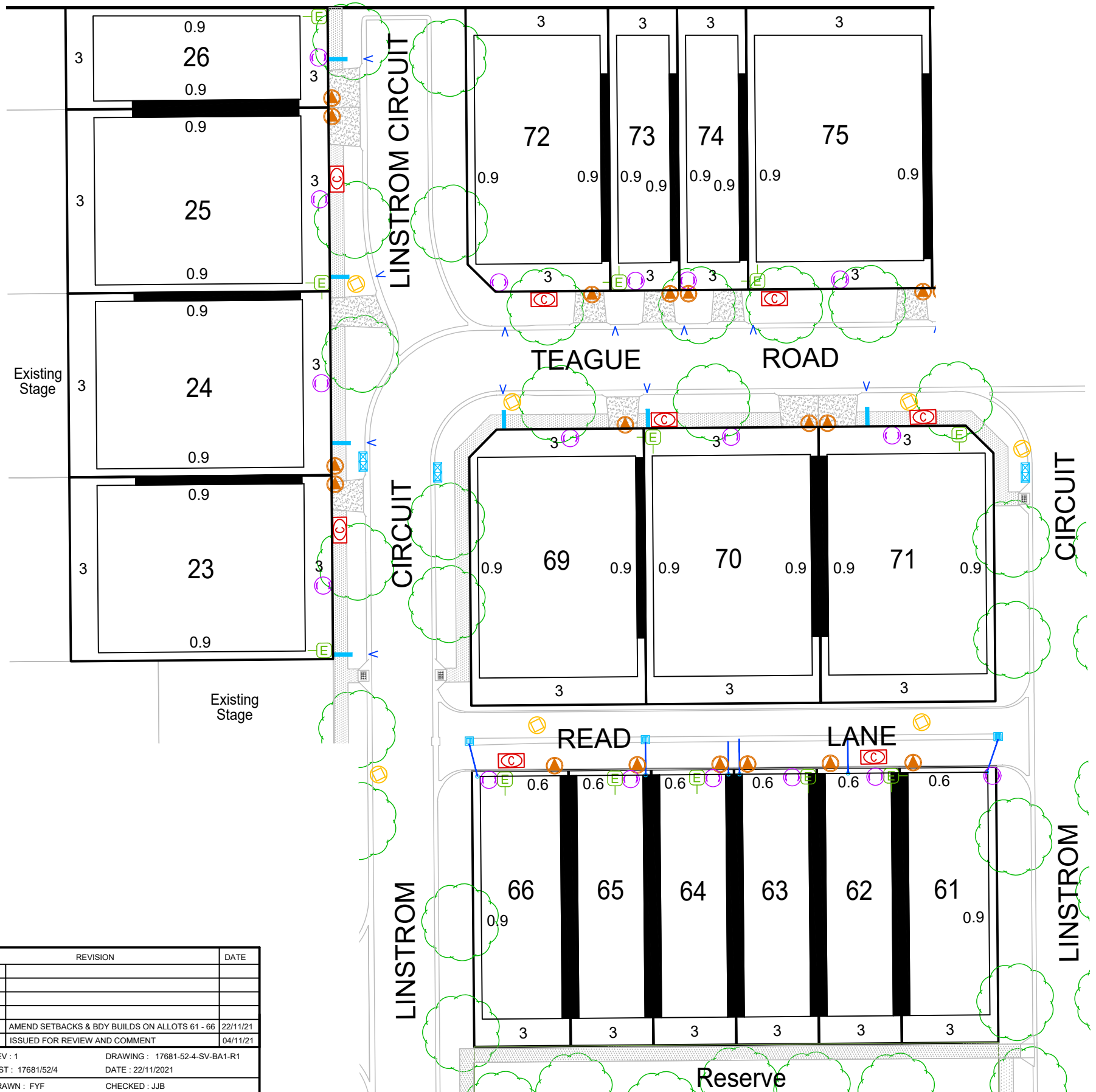

REVISION	DATE	
1	AMEND SETBACKS & BDY BUILDS ON ALLOTS 61 - 66	22/11/21
0	ISSUED FOR REVIEW AND COMMENT	04/11/21
REV : 1	DRAWING : 17681-52-4-SV-BA1-R1	
INST : 17681/52/4	DATE : 22/11/2021	
DRAWN : FYF	CHECKED : JJB	



Original Sheet Size A3